

# ASSEMBLY INSTRUCTION

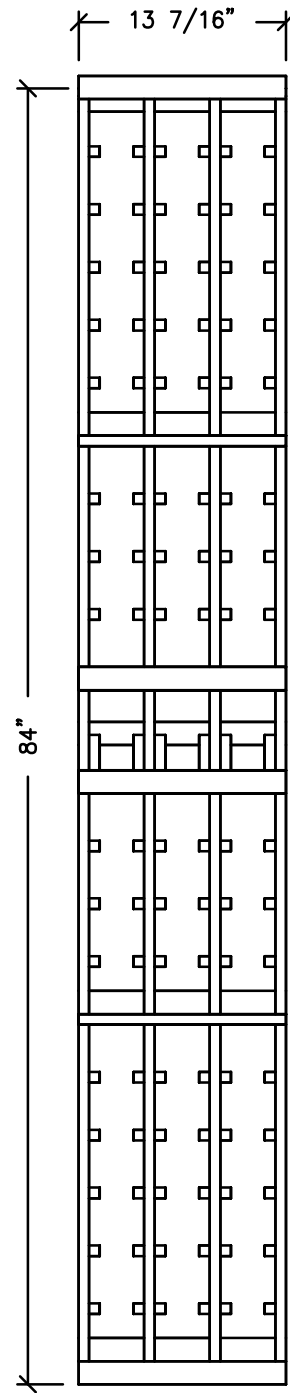

**IB-3COL-7**  
**Front view**

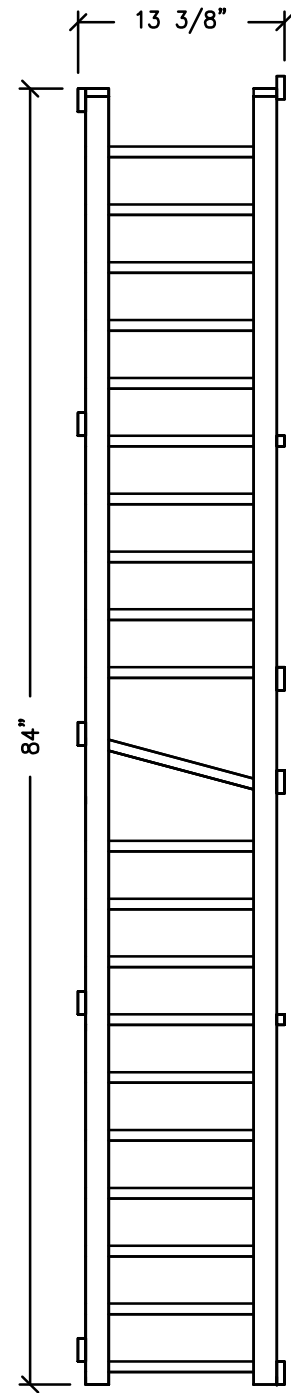

**IB-3COL-7**  
**Side view**

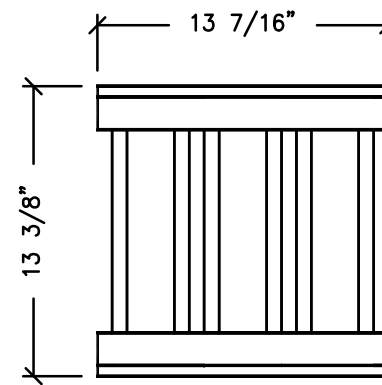

**IB-3COL-7**  
**Top view**

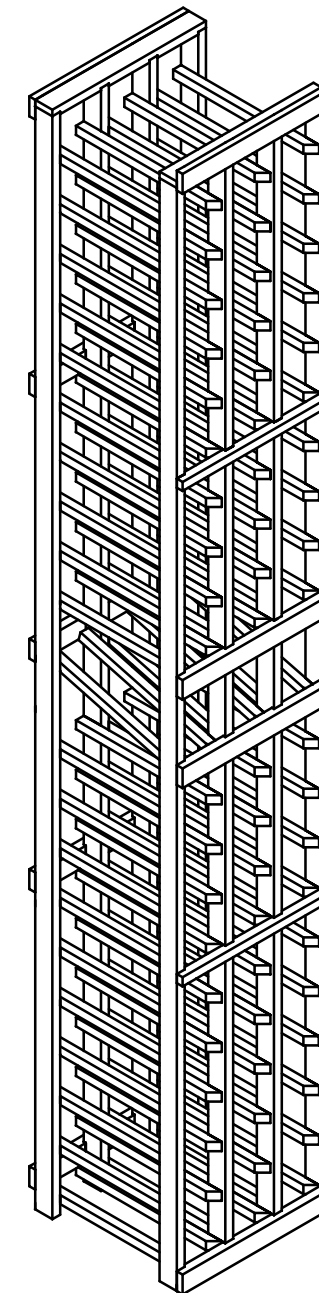

**ISOMETRIC**

P-1

REVISION	KIT NAME: Individual 3 Columns	
0	No. IB-3COL-7	NOTES: 1.- 11/16" THICKNESS 2.- PRODUCTION TOLERANCE 0-1/16" 3.- ALL DIMENSION HAVE TO VERIFY ON FIELD
	DATE: APR/25/18	
	DRAW: DANIEL D.	



REVISIONS		
REV.	DATE	DESCRIPTION

APPROVED BY:
DATE:

\*Proprietary Trademark Infringement- Designs are proprietary and cannot be copied or shared with others without our written consent.

# ASSEMBLY INSTRUCTION

LEFT & RIGHT LADDERS

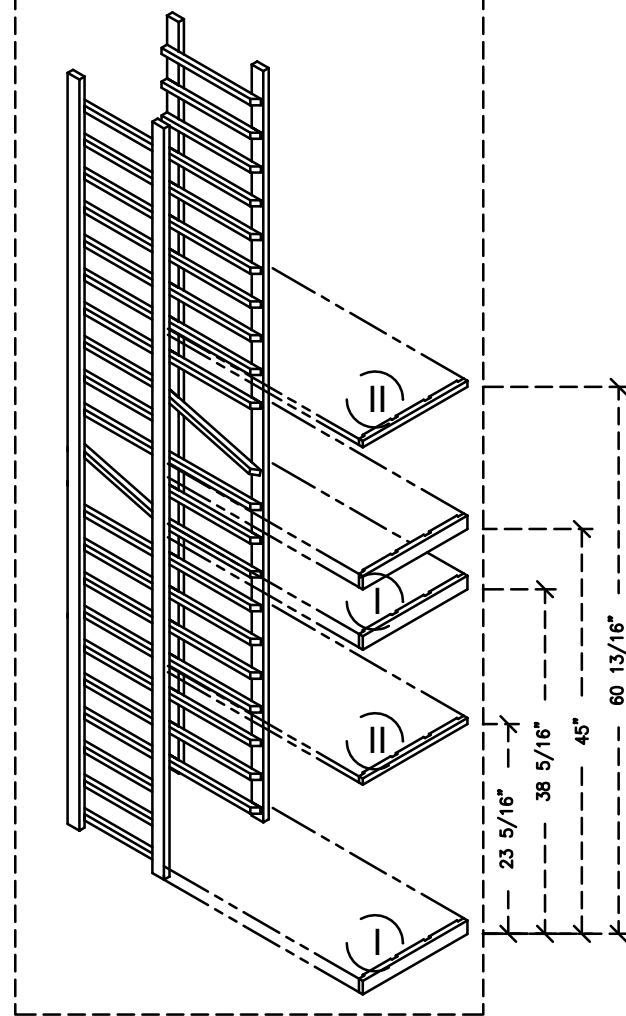

Step 1.- Stand the left and right ladders making sure the angle display is facing you, then place the front stabilizers at the indicated dimensions. Nail each ladder onto stabilizers.

MIDDLE LADDERS

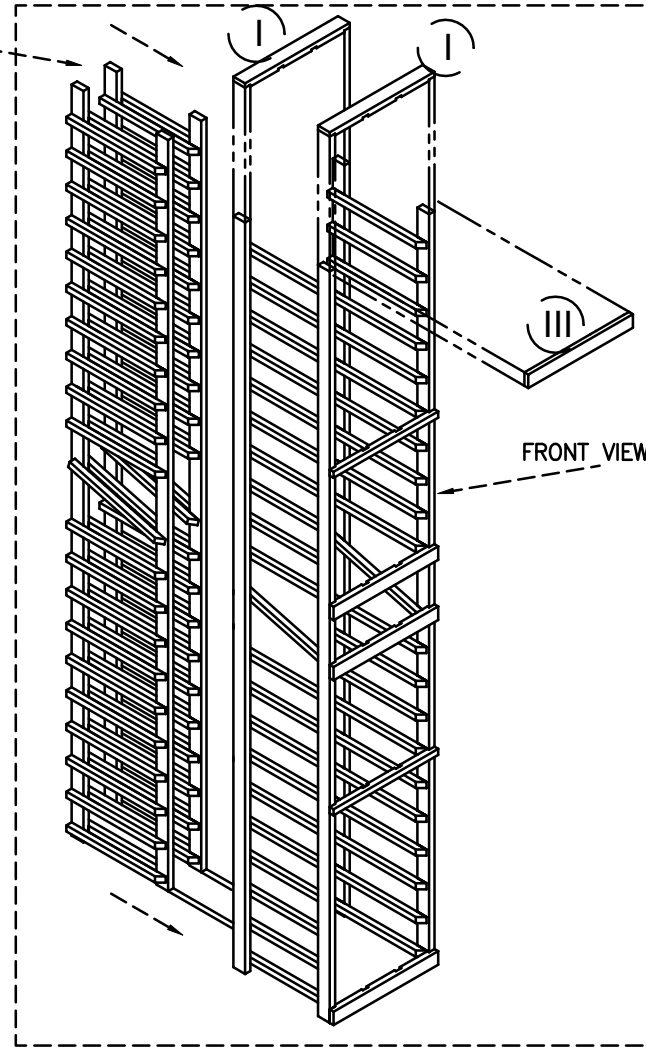

Step 2.- Insert the middle ladders into the slots of the stabilizer. Once inserted, place the top stabilizers and top flat trim. Nail each middle ladder onto stabilizers.

BACK VIEW

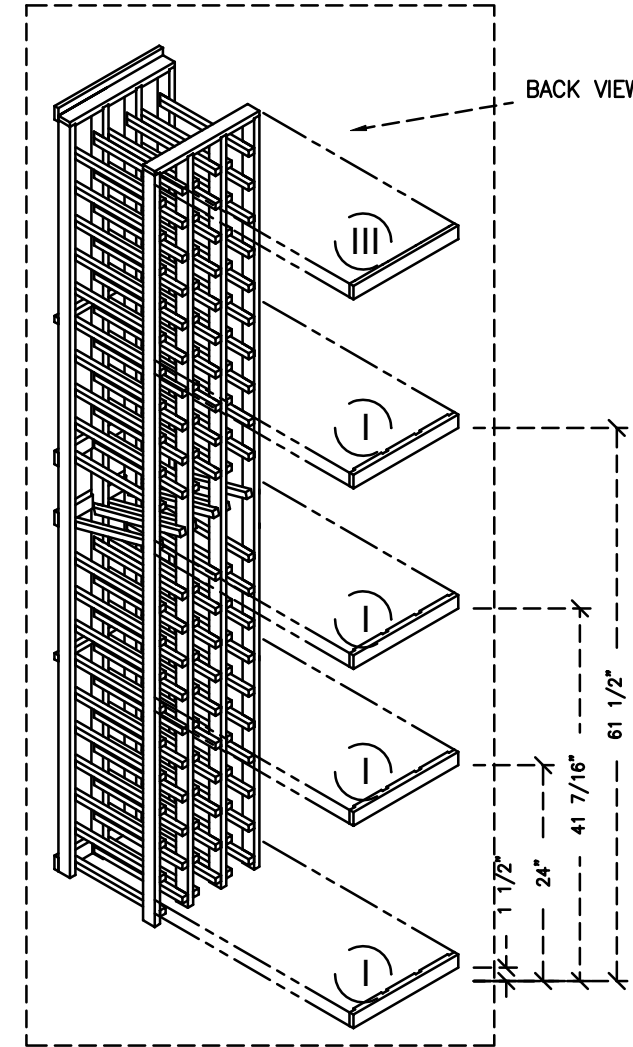

Step 3.- Attach the back stabilizers at the indicated dimensions. Nail each ladder onto stabilizers.

Note: All dimensions are from floor to bottom of stabilizers.

Note: The last stabilizers are flat trims. You may attach at the height you need.

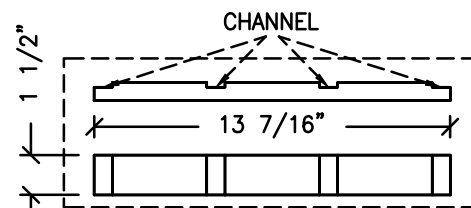

I FRONT & BACK STABILIZER 9PZ

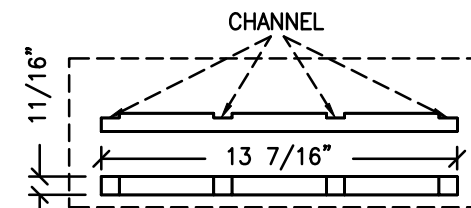

II FRONT STABILIZER 2PZ

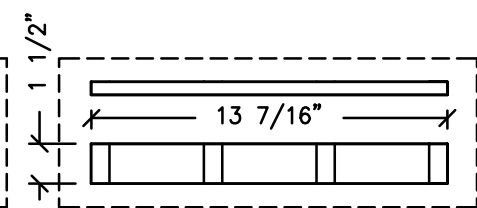

III TOP FLAT TRIM 2PZ

P-2

REVISION KIT NAME: Individual 3 Columns

0

No. IB-3COL-7  
DATE: APR/25/18  
DRAW: DANIEL D.

NOTES:  
1.- 11/16" THICKNESS  
2.- PRODUCTION TOLERANCE 0-1/16"  
3.- ALL DIMENSION HAVE TO VERIFY ON FIELD



REVISIONS		
REV.	DATE	DESCRIPTION

APPROVED BY:

DATE: